

LHM2-P – HDMI Active Optical Cable

■ Overview

LH2-Pxxx is an HDMI 2.0 Pluggable AOC (active optical cable) that enables users to experience a generic Plug-and-Play and uncompressed interconnect for distributing HDMI streams beyond the conventional reach of copper-based HDMI cables. This miniature active fiber optic cable reaches up to 100 meters (328 feet) and supports a handy and power-efficient HDMI extensions from STB, DVD players, Blu-ray players or game consoles to different types of display devices including projectors and 4K 60Hz UHD-capable TV or monitors. Users of this cable are able to enjoy the state-of-the-art advances in HDMI technologies along with 4K 60Hz UHD resolutions, 3D, deep colors.



LHM2-Pxx cable is superior to other cables in its physical form-factors and performances. The cable is thin (0.15 inches) and light (0.4lbs/33ft) and robust (500N pulling and crush load strength) and takes a hybrid topology where 4 strands of fiber optic cables carry around the TMDS payload and the 6 strands of insulated copper wires work with hot plug origination and voltage assertion hardware handshakes.

Additionally, the cables internationally comply with European and North American flame-retardant requirements with its low smoke halogen-free and CMP-OF plenum rated cable jacket materials. The optical fiber cable delivers several advantages over copper cabling by reducing the risk of EMI and RFI degradation for stable performance when used in typically high interference environments such as in data centers, operating rooms or manufacturing facilities where high resolution and 24/7 operation for displays is required. The cables does require an external power supply and it is powered exclusively by the HDMI source. Any source devices supplying insufficient non-HDMI standard current with below 50mA works with LHM2-Pxxx cable and its external micro USB power supply cable.

■ Features

- Support resolutions up to 4K 60Hz, 3D & Deep Color
- Multi-channel Audio, Dolby TrueHD, DTS-HD Master Audio
- HDMI Compliant: EDID, CEC. Note (HDCP: Pass Through for 2.2 and earlier versions)
- Reduced EMI & RFI
- Plug & Play Operation (No redundant firmware setting process is required.)
- Integrator-oriented removable HDMI-A ends for easy advanced wiring
- Interoperable field flexibility: HDMI-D with HDMI-A & HDMI-D with DVI-D single link
- External 5V micro USB power supply cable
- Robust Cable Pulling Strength & Compression Load Resistance
- Compliant with International Flame Retardant Standards: UL CMP-OF (Plenum), IEC LSZH (Low Smoke Zero Halogen)

■ Applications

- Professional AV System Interconnection
- In & Outdoor Digital Signage Panels & Kiosks
- Home Theater Systems
- Facility Automation Systems

■ Detachable Solution

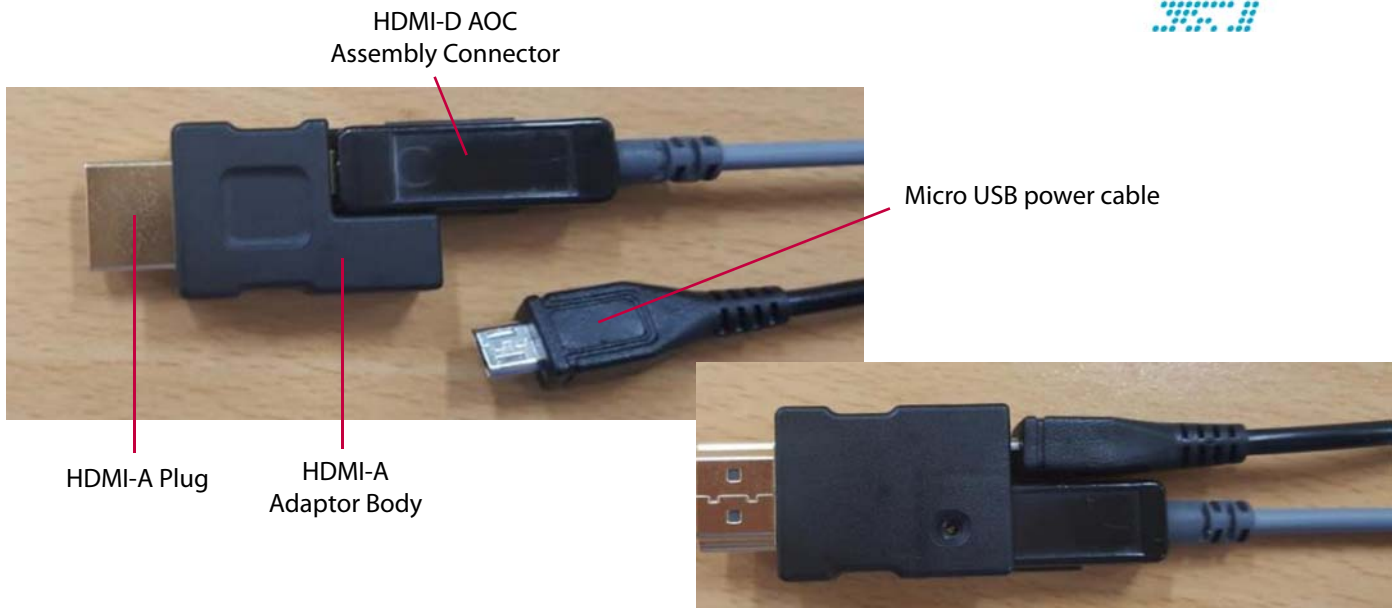

■ Product Dimensions Unit of Measure [mm]

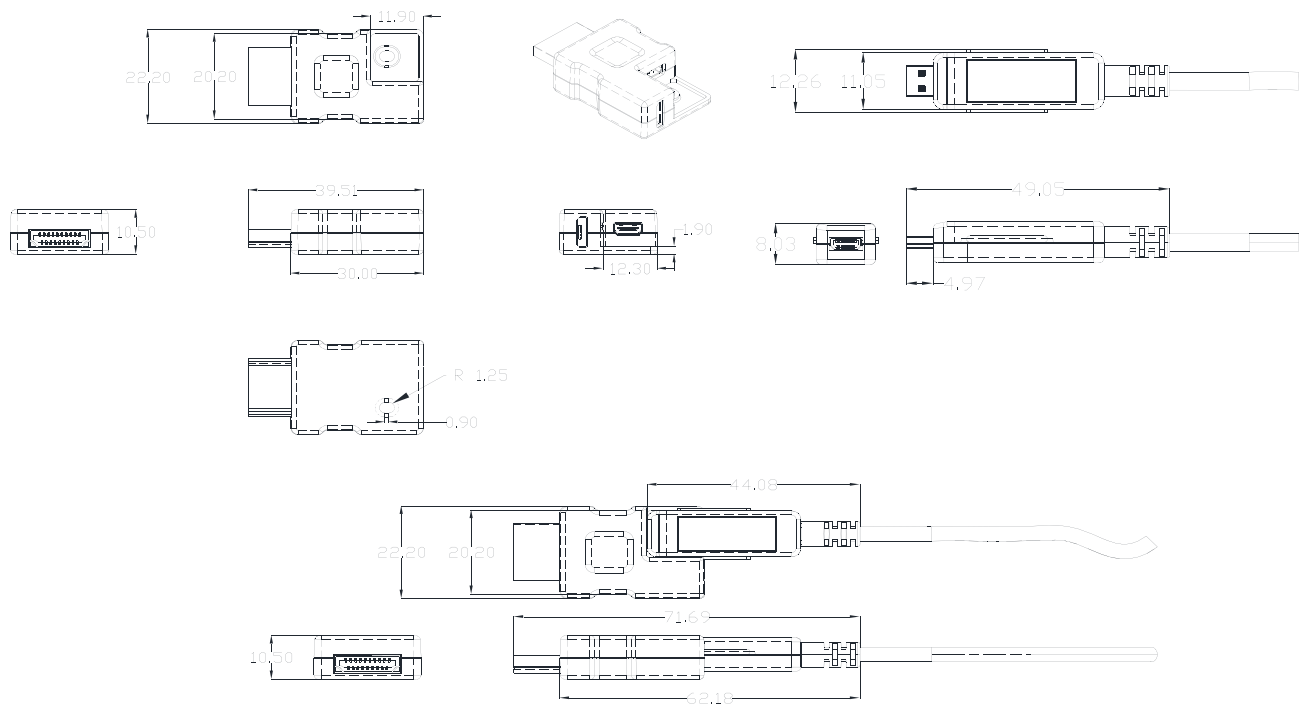

■ Order information

Model	Length	Order number
LHM2-PL10	10m	8686-0003-10
LHM2-PL15	15m	8686-0003-15
LHM2-PL20	20m	8686-0003-20
LHM2-PL30	30m	8686-0003-30
LHM2-PL40	40m	8686-0003-40
LHM2-PL50	50m	8686-0003-50

Model	Length	Order number
LHM2-PL60	60m	8686-0003-60
LHM2-PL70	70m	8686-0003-70
LHM2-PL80	80m	8686-0003-80
LHM2-PL90	90m	8686-0003-90
LHM2-PLA0	100m	8686-0003-99