

## Rack-mountable Power Supply for Lightware Interfaces



Part No: See below

### Highlight Features

- Direct 1U rack mount
- Universal full range AC input
- Available with 5V or 12V power outputs
- Available with 10 or 20 DC output connectors

Power supply is a very basic requirement for all electrical devices worldwide, yet it's hard to find a really reliable high quality PSU.

Lightware provides four types of multiple output power supplies. All of them accept 115-230VAC, 47-63Hz housed in a 1U metal rack enclosure for durability and easier mounting. 5V and 12V DC output versions are available with either 10 or 20 separate output connectors, each version is cooled by two fans integrated on the left side of the housing.

These PSUs are designed to power up 10 to 20 Lightware products like the TP and OPT extenders, distribution amplifiers and the EDID Manager V4 with 100.000 hours MTBF value. Several protections are built in against short circuits, overloads, over voltage, and overheating, features which make these PSUs very reliable.

### Available Models

Products	Part No
PSUx10-200-12V (for Lightware 12 Volt interfaces, 200 Watt, 10x12V output)	9134 0001
PSUx10-200-5V (for Lightware 5 Volt interfaces, 200 Watt, 10x5V output)	9134 0002
PSUx20-400-12V (for Lightware 12 Volt interfaces, 400 Watt, 20x12V output)	9134 0003
PSUx20-400-5V (for Lightware 5 Volt interfaces, 400 Watt, 20x5V output)	9134 0004

### Front and Rear View



PSUx10-200-5V



PSUx10-200-12V



PSUx20-400-5V



PSUx20-400-12V

# PSUx10-200 and PSUx20-400

## Features:

- Direct 1U rack mount
- Universal full range AC input
- Available with 5V or 12V power outputs
- Available with 10 or 20 output connectors
- 100.000 hours MTBF
- Two cooling fans integrated
- Built-in active PFC function
- High efficiency up to 90% (typical)
- Protections: Short circuit / Overload / Over voltage / Over temperature
- 3 years warranty

## Connectors

AC power input connector:	IEC C14
5V DC power output connectors	2.5/5.5 mm locking DC connector
12V DC power output connectors	2.1/5.5 mm locking DC connector

## Locking DC plug

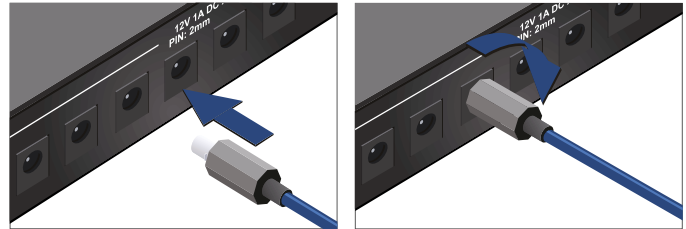

Twist 90° clockwise to lock

## Specifications

Models	PSUx10-200-5V	PSUx20-400-5V	PSUx10-200-12V	PSUx20-400-12V
DC output number	10	20	10	20
Nominal power	200 W	400 W	200 W	400 W
DC output voltage	5V		12V	
Rated current per output port	2.5A		1.1A	
Max. input AC current	2.2A/115 V AC		1.2A/230 V AC	
MTBF (min.)	108.4 Khrs			
Cooling fan number	2			
Cooling fan size	40 x 40 x 20 mm			
Input voltage range	90 ~ 264 V AC			
Input frequency range	47 ~ 63 Hz			
Operating temperature	-20 ~ +70 °C			
Rack height	1U			
Enclosure	metal			
Dimensions	446(482) W x 182 D x 43.9 H mm			
Weight	2.87 kg	3.43 kg	2.87 kg	3.43 kg
Compliance	CE			
Warranty	3 years			

## Optional accessories

Product name	Description	PSU models			
		PSUx10-200-5V	PSUx10-200-12V	PSUx20-400-5V	PSUx20-400-12V
CAB-12V-U16U	12V 160cm power cable with red end 2.1/5.5 mm DC Power Plug	x	✓	x	✓
CAB-5V-U16U	5V 160cm power cable with 2.5/5.5 mm DC Power Plug	✓	x	✓	x
CAB-5V-U16S	5V 160cm power cable with 1.35/3.5 mm DC Power Plug	✓	x	✓	x
CAB-5V-U16M	5V 160cm power cable with USB Micro-B Plug	✓	x	✓	x

Cables available for order in 10 piece packs.

# PSUx10-200 and PSUx20-400

## Available 5V cables:

### CAB-5V-U16U

#### Compatible products:

- EDID Manager V4
- DVISL-Extender
- DVIDL-Extender
- HDMI-Extender
- DA2DVI-HDCP-Pro
- DA2DVI-DL
- DP-OPT-RX100
- DP-OPT-TX100
- DVIDL-OPT-RX100
- DVIDL-OPT-TX200
- HDMI-OPT-RX100
- HDMI-OPT-TX100
- HDMI-OPT-RX100R
- HDMI-OPT-TX100R
- HDMI-OPT-RX200R
- HDMI-OPT-TX200R
- UMX-OPT-TX150R
- DVI-TP-RX100
- DVI-TP-RX100DL
- DVI-TP-TX200
- DVI-TP-TX200DL
- DVI-TP-TX300
- Remote control panels

### CAB-5V-U16S

#### Compatible products:

- DVI-OPT-RX110
- DVI-OPT-TX110
- DP-OPT-RX150
- DP-OPT-TX150

### CAB-5V-U16M

#### Compatible products:

- DVI-HDCP-OPTS-RX90
- DVI-HDCP-OPTS-TX90
- DVI-HDCP-OPTM-RX90
- DVI-HDCP-OPTM-TX90

## Available 12V cables:

### CAB-12V-U16U

#### Compatible products:

- BR-TP-COM
- UMX-TPS-TX120
- UMX-TPS-TX130
- UMX-TPS-TX140
- DVI-HDCP-TPS-TX210
- DVI-HDCP-TPS-TX220
- HDMI-TPS-TX210
- HDMI-TPS-TX220
- DP-TPS-TX210
- DP-TPS-TX220
- SW4-TPS-TX240
- HDMI-TPS-RX90
- HDMI-TPS-TX90
- DVI-HDCP-TP-RX100R
- DVI-HDCP-TP-RX50
- DVI-HDCP-TP-TX100R
- DVI-HDCP-TP-TX50
- HDMI-TP-RX100R
- HDMI-TP-RX100RA
- HDMI-TP-RX200R
- HDMI-TP-RX50
- HDMI-TP-TX100R
- HDMI-TP-TX200R
- HDMI-TP-TX50
- UMX-TP-TX100R
- HDMI-TPS-RX95
- HDMI-TPS-TX95
- DVI-HDCP-TPS-RX95
- DVI-HDCP-TPS-TX95
- HDMI-TPS-RX97
- HDMI-TPS-TX97
- DVI-HDCP-TPS-RX97
- DVI-HDCP-TPS-TX97